

# Belanko™ S



S I M P L I C I T Y

M E E T S S T Y L E

## CONTENTS

- 02 Stylish design
- 04 Safe and swift installation
- 06 Strong offerings
- 08 Sensible functions for hotels
- 10 Scalable setup
- 12 Catalogue pages
- 19 Selection charts

STYLE

SIMPLICITY

SAFETY





# STYLISH DESIGN



## Timeless classics meet a new favourite

There is always room for the basic white and ivory colours because they blend perfectly with every room design. For something different, **Belanko™ S** also offers the anthracite finish.

Glossy finish for easy cleaning

Thin matt finish edging for a distinctive look

Slim profile for a modern touch

### Subtle enhancements that make a difference

Essentials always work. **Belanko™ S** ticks all the boxes for the essential range with a little extra – premium quality, clean lines, smooth surface and slim profile.



White



Anthracite



Ivory<sup>1</sup>



# SAFE AND SWIFT INSTALLATION

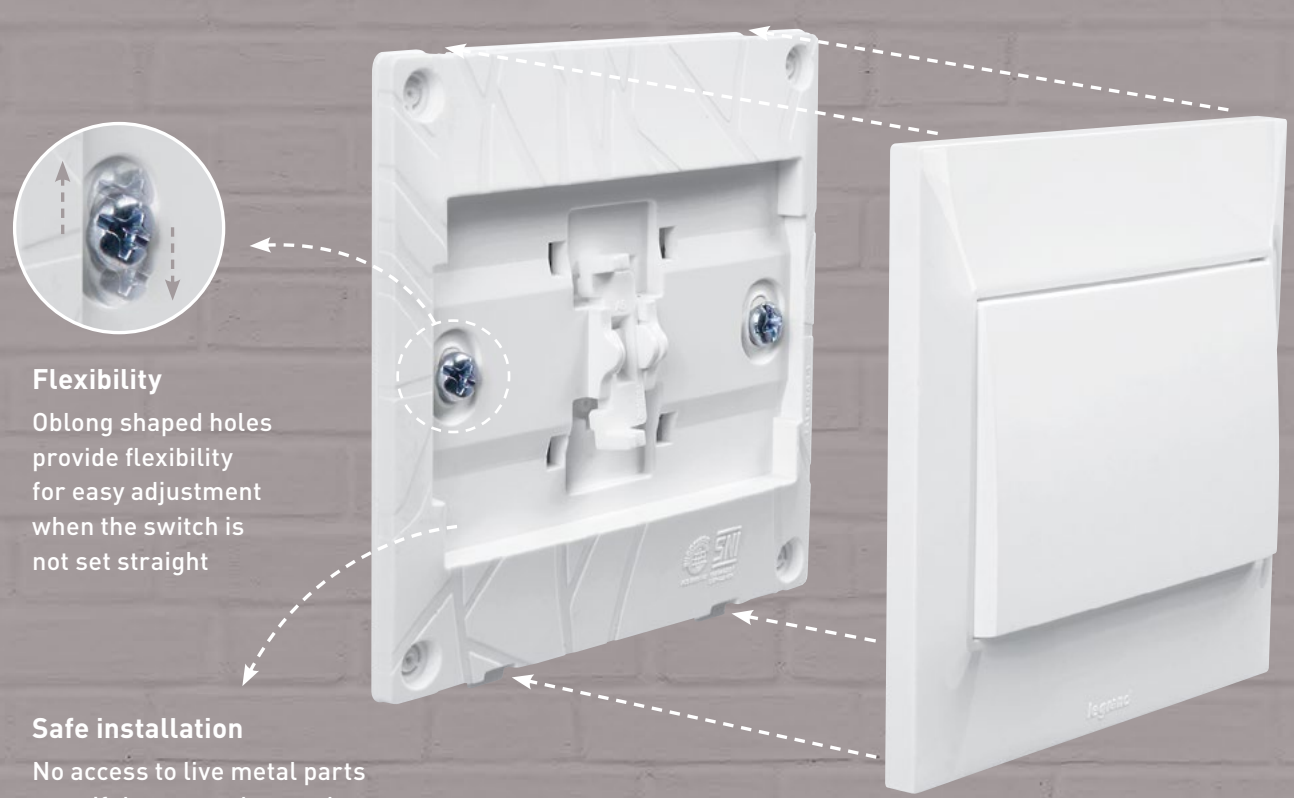

**Flexibility**  
Oblong shaped holes provide flexibility for easy adjustment when the switch is not set straight

**Safe installation**  
No access to live metal parts even if the cover plate and plate are not installed



**All-in-one**  
Switch plate and rocker are supplied as a set to enable quick installation

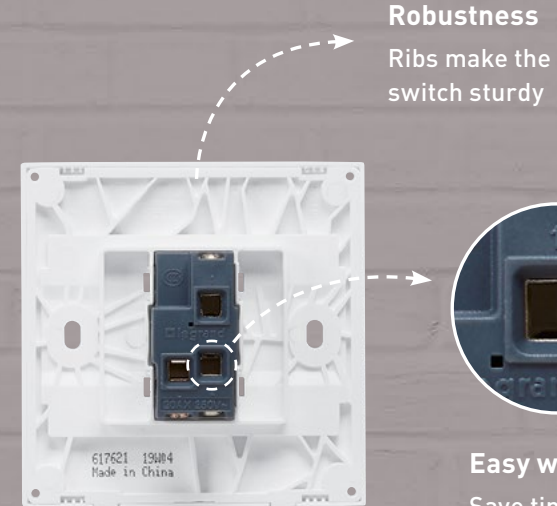

**Robustness**  
Ribs make the switch sturdy

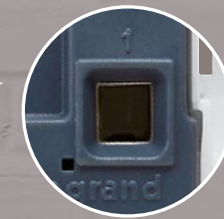

**Easy wiring**  
Save time with ready-to-wire screw terminals

## Safer for the installer, safer for the user

We share the same goal. To get the job done fast, safely and perfectly. **Belanko™ S** was engineered to meet just that purpose.

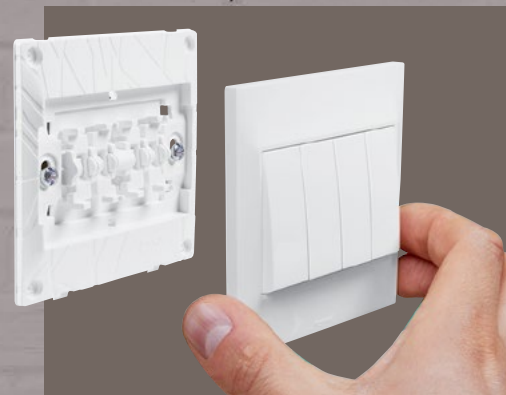

**Just one click**  
Clip up to a 4 gang switch single-handed



**Perfect protection for a neat result**  
The soft protection film keeps the product safe from dust and scratches until the work has been completed. Only the soft protection film will get stained by the ongoing wall paintwork.





# STRONG OFFERINGS

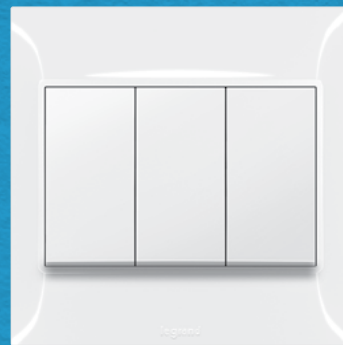

3 gang switch

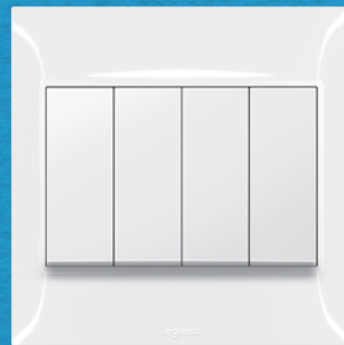

4 gang switch

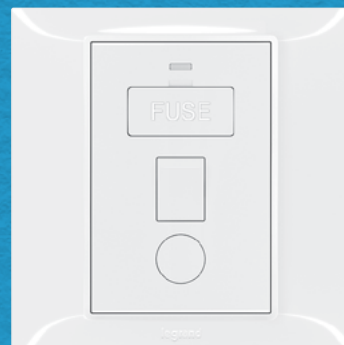

Switched fused connection unit with neon and cord outlet

Above standard selection for standard homes

There is no place like home. Make it comfortable and optimal for modern lifestyles.



Universal dimmer suitable for all modern loads



Dimmable LEDs



Dimmable compact fluorescent lamps



Halogen with electronic or ferromagnetic transformer



Incandescent and halogen lamps



BS socket outlet with USB A-Type charger and IP55 cover



**Suitable for outdoor use**

The splash-proof cover allows a 1 gang Belanko™ S mechanism to be installed in outdoor environments. It also ensures protection against dust. With plug engaged, IP55 protection is maintained.



# SENSIBLE FUNCTIONS FOR HOTELS



Indicator for corridor



Key card switch



Internal control unit



Keystone data socket



## A comprehensive range of hospitality applications

The best compliment for a hotel is when guests feel at home. Now, be a hospitable host at all times with **Belanko™ S** thanks to its hospitality functions.

Compliant with Guest Room Management Systems for hotel operators to efficiently control and manage facilities





# SCALABLE SETUP

## Infinite possibilities with limitless combinations

There is no need to settle for less. **Belanko™ S** works both independently and with the Arteor range. The Arteor adaptor offers perfect versatility for your every need – hospitality, residential and commercial projects.

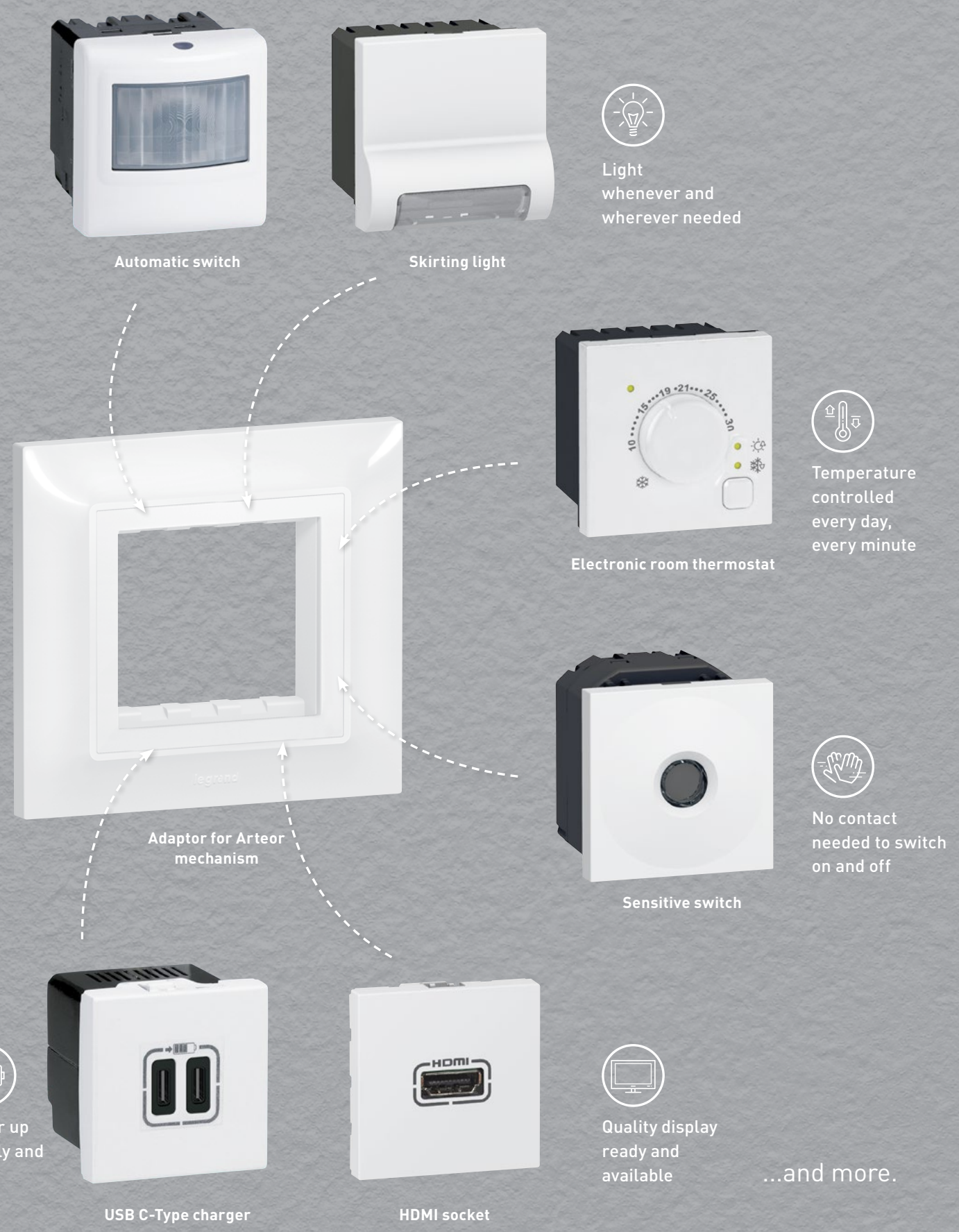

...and more.





6 176 01      6 176 05      6 176 07      6 176 11      6 176 16

Conform to BS EN 60669-1  
Material: Thermoplastic with glossy finish  
Dimensions: 86 x 86 x 9.5 mm (1 gang)  
Supplied with 2 screws M3.5 for BS boxes

Pack	Cat.Nos	Single pole switches 16 AX - 250 V~
10	6 176 01	<b>1 gang - 1-way switch</b> ○ White ● Anthracite ● Ivory
10	6 177 00	
10	6 178 00 <sup>1</sup>	
10	6 176 01	<b>1 gang - 2-way switch</b> ○ White ● Anthracite ● Ivory
10	6 177 01	
10	6 178 01 <sup>1</sup>	
10	6 176 02	<b>2 gang - 1-way switch</b> ○ White ● Anthracite ● Ivory
10	6 177 02	
10	6 178 02 <sup>1</sup>	
10	6 176 03	<b>2 gang - 2-way switch</b> ○ White ● Anthracite ● Ivory
10	6 177 03	
10	6 178 03 <sup>1</sup>	
10	6 176 09	<b>Intermediate switch</b> ○ White ● Anthracite ● Ivory
10	6 177 09	
10	6 178 09 <sup>1</sup>	
10	6 176 04	<b>3 gang - 1-way switch</b> ○ White ● Anthracite ● Ivory
10	6 177 04	
10	6 178 04 <sup>1</sup>	
10	6 176 05	<b>3 gang - 2-way switch</b> ○ White ● Anthracite ● Ivory
10	6 177 05	
10	6 178 05 <sup>1</sup>	
10	6 176 06	<b>4 gang - 1-way switch</b> ○ White ● Anthracite ● Ivory
10	6 177 06	
10	6 178 06 <sup>1</sup>	
10	6 176 07	<b>4 gang - 2-way switch</b> ○ White ● Anthracite ● Ivory
10	6 177 07	
10	6 178 07 <sup>1</sup>	

Pack	Cat.Nos	Single pole switches 20 AX - 250 V~
10	6 176 20	<b>1 gang - 1-way switch</b> ○ White ● Anthracite ● Ivory
10	6 177 20	
10	6 178 20 <sup>1</sup>	
10	6 176 21	<b>1 gang - 2-way switch</b> ○ White ● Anthracite ● Ivory
10	6 177 21	
10	6 178 21 <sup>1</sup>	
10	6 176 22	<b>2 gang - 1-way switch</b> ○ White ● Anthracite ● Ivory
10	6 177 22	
10	6 178 22 <sup>1</sup>	
10	6 176 23	<b>2 gang - 2-way switch</b> ○ White ● Anthracite ● Ivory
10	6 177 23	
10	6 178 23 <sup>1</sup>	
10	6 176 24	<b>3 gang - 1-way switch</b> ○ White ● Anthracite ● Ivory
10	6 177 24	
10	6 178 24 <sup>1</sup>	
10	6 176 25	<b>3 gang - 2-way switch</b> ○ White ● Anthracite ● Ivory
10	6 177 25	
10	6 178 25 <sup>1</sup>	

Pack	Cat.Nos	Push-buttons 6 A - 250 V~
10	6 176 10	<b>1 gang</b> ○ White ● Anthracite ● Ivory
10	6 177 10	
10	6 178 10 <sup>1</sup>	
10	6 176 15	<b>2 gang</b> ○ White ● Anthracite ● Ivory
10	6 177 15	
10	6 178 15 <sup>1</sup>	
10	6 176 11	<b>Bell push</b> ○ White ● Anthracite ● Ivory
10	6 177 11	
10	6 178 11 <sup>1</sup>	
10	6 176 16	<b>2 gang for shutters</b> ○ White ● Anthracite ● Ivory
10	6 177 16	
10	6 178 16 <sup>1</sup>	

1: Available on request



6 176 72      6 176 76

Material: Thermoplastic with glossy finish  
Dimensions: 86 x 86 x 9.5 mm (1 gang) / 86 x 146 x 9.5 mm (2 gang)  
Supplied with 2 screws M3.5 for BS boxes

Pack	Cat.Nos	Double pole switches 20 A - 250 V~
10	6 176 73	<b>1 gang - 1-way switch</b> ○ White ● Anthracite ● Ivory
10	6 177 73	
10	6 178 73 <sup>1</sup>	
10	6 176 70	<b>1 gang - 1-way switch + red neon indicator</b> ○ White ● Anthracite ● Ivory
10	6 177 70	
10	6 178 70 <sup>1</sup>	
10	6 176 71	<b>1 gang - 1-way switch + red neon indicator + earth connection</b> ○ White ● Anthracite ● Ivory
10	6 177 71	
10	6 178 71 <sup>1</sup>	
10	6 176 72	<b>1 gang - 1-way switch + red neon indicator + earth connection with "Water Heater" marking</b> ○ White ● Anthracite ● Ivory
10	6 177 72	
10	6 178 72 <sup>1</sup>	
5	6 176 75	<b>Double pole switches 45 A - 250 V~</b> <b>1 gang - 1-way switch</b> ○ White ● Anthracite ● Ivory
5	6 177 75	
5	6 178 75 <sup>1</sup>	
5	6 176 76	<b>1 gang - 1-way switch + red neon indicator</b> ○ White ● Anthracite ● Ivory
5	6 177 76	
5	6 178 76 <sup>1</sup>	
5	6 176 77	<b>2 gang - 1-way vertical switch + red neon indicator</b> ○ White ● Anthracite ● Ivory
5	6 177 77	
5	6 178 77 <sup>1</sup>	
5	6 176 78	<b>Cooker control unit - 250 V</b> <b>45 A double pole switch + red neon and 13 A BS switched socket outlet + red neon</b> ○ White ● Anthracite ● Ivory
5	6 177 78	
5	6 178 78 <sup>1</sup>	

1: Available on request



6 176 35      6 176 33

Material: Thermoplastic with glossy finish  
Dimensions: 86 x 86 x 9.5 mm (1 gang)  
Supplied with 2 screws M3.5 for BS boxes

Pack	Cat.Nos	Dimmers
1	6 176 31	<b>500 W RL dimmer</b> Push on/off and rotary dimmer - 50/60 Hz 1 gang - 2-way : - 60-500 W (127 V) for incandescent and halogen lamps - 60-600 VA (230 V) / 60-300 VA (127 V) for halogen lamps with electronic transformer with leading edge behaviour - 60-500 VA (127 V) for halogen lamps with ferromagnetic transformers Slider at the back to select 230 V or 127 V ○ White ● Anthracite ● Ivory
1	6 177 31	
1	6 178 31 <sup>1</sup>	
1	6 176 35	<b>300 W RLC+LED dimmer</b> For all types of lamps: - dimmable LEDs: 5 W to 75 W (10 lamps max. 5 W to 37 W (127 V)) - dimmable compact fluorescent lamps: 5 W to 75 W (10 lamps max. 5 W to 37 W (127 V)) - halogen with ferromagnetic or electronic transformer: 5 VA to 300 VA / 5 VA to 150 VA (127 V) - fluorescent tube - ballast: 5 VA to 300 VA / 5 VA to 150 VA (127 V) - halogen and incandescent 240 VA: 5 W to 300 W / 5 W to 150 W (127 V) When switched on, gradually (2 seconds) lights up at the level set before last switch-off ○ White ● Anthracite ● Ivory
1	6 177 35	
1	6 178 35 <sup>1</sup>	
1	0 401 49	<b>Active Power Compensator</b> Makes 2-wire electronic lighting control units without neutral compatible with all commercially-available loads (LED, compact fluorescent, ELV halogen with ferromagnetic or electronic ballast, 230 V halogen, fluorescent tube, incandescent) Consumption 0.4 W 
1	6 176 33	<b>Ventilation control</b> Conform to BS EN 60669-1 <b>Fan control 250 V~ - 50 Hz</b> ○ White ● Anthracite ● Ivory
1	6 177 33	
1	6 178 33 <sup>1</sup>	

1: Available on request





6 176 27      6 176 38      6 176 95      6 176 91      6 176 34

Material: Thermoplastic with glossy finish  
Dimensions: 86 x 86 x 9.5 mm  
Supplied with 2 screws M3.5 for BS boxes

Pack	Cat.Nos	Television sockets
10	6 176 27	<b>Single TV socket, female</b> ○ White ● Anthracite ● Ivory
10	6 177 27	
10	6 178 27 <sup>1</sup>	
10	6 176 26	<b>Single TV socket, "F" type</b> ○ White ● Anthracite ● Ivory
10	6 177 26	
10	6 178 26 <sup>1</sup>	
10	6 176 38	<b>Double TV socket, female + "F" type</b> ○ White ● Anthracite ● Ivory
10	6 177 38	
10	6 178 38 <sup>1</sup>	
10	6 176 30	<b>TV-R socket</b> ○ White ● Anthracite ● Ivory
10	6 177 30	
10	6 178 30 <sup>1</sup>	
10	6 176 97	<b>Telephone sockets</b>
10	6 177 97	
10	6 178 97 <sup>1</sup>	
10	6 176 98	<b>Double RJ 11 socket</b> ○ White ● Anthracite ● Ivory
10	6 177 98	
10	6 178 98 <sup>1</sup>	

Pack	Cat.Nos	Data sockets
10	6 176 91	<b>RJ 45 Cat.6 UTP</b> ○ White ● Anthracite ● Ivory
10	6 177 91	
10	6 178 91 <sup>1</sup>	
10	6 176 92	<b>Double RJ 45 Cat.6 UTP</b> ○ White ● Anthracite ● Ivory
10	6 177 92	
10	6 178 92 <sup>1</sup>	
10	6 176 17	<b>1 gang - single Keystone adaptor</b> ○ White ● Anthracite ● Ivory
10	6 177 17	
10	6 178 17 <sup>1</sup>	
10	6 176 34	<b>1 gang - double Keystone adaptor</b> ○ White ● Anthracite ● Ivory
10	6 177 34	
10	6 178 34 <sup>1</sup>	

1: Available on request



6 176 12      6 176 37 + 5 720 78

Material: Thermoplastic with glossy finish  
Dimensions: 86 x 86 x 9.5 mm (1 gang)  
Supplied with 2 screws M3.5 for BS boxes

Pack	Cat.Nos	Key card switch
1	6 176 12	16 A - 230 V~ - 50/60 Hz Time delay of approx. 30 s after card removal Use card with width max. 54 mm ○ White ● Anthracite ● Ivory
1	6 177 12	
1	6 178 12 <sup>1</sup>	
10	6 176 13	<b>Hotel bedrooms call indicators</b> 2 settings : - Do not disturb - Please clean the room <b>Indicator for corridor</b> Installed in the corridor, displays calls ○ White ● Anthracite ● Ivory
10	6 177 13	
10	6 178 13 <sup>1</sup>	
10	6 176 14	<b>Internal control unit</b> Installed in the room, allows the user to select the desired setting ○ White ● Anthracite ● Ivory
10	6 177 14	
10	6 178 14 <sup>1</sup>	
1	6 176 19	<b>Security switch</b> 1 A resistive - 250 V~ <b>Panic button</b> ○ White ● Anthracite ● Ivory
1	6 177 19	
1	6 178 19 <sup>1</sup>	
20	6 176 37	<b>Arteor adaptor</b> Allows the integration of 2 modules Arteor mechanisms such as R.C.B.O., automatic switch, skirting light, USB charger, etc <b>1 gang</b> ○ White

1: Available on request

Guest Room Management System

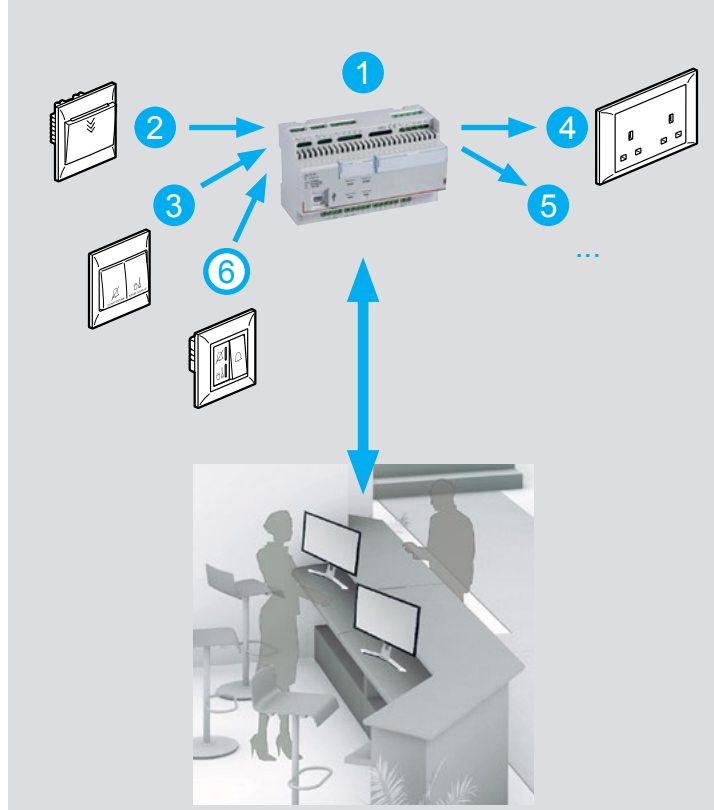

The Room Controller Unit, Cat.No 048408 or 048412, associated with mechanical Belanko™ S functions can manage the lights, sockets outlet, ventilation and curtains independently in each room. It can be integrated with the Building Management System (BMS) and the Property Management System (PMS) in order to enable a global management of the building and the hotel's operations.

For integration of Arteor functions, see Arteor offer



For complementary information on the Room controller, please contact us





Belanko™ S

socket outlets



6 176 43

Material: Thermoplastic with glossy finish  
Dimensions: 86 x 86 x 9.5 mm (1 gang) / 86 x 146 x 9.5 mm (2 gang).  
Supplied with 2 screws M3.5 for BS boxes

**British Standard socket outlets 13 A - 250 V~**

Pack	Cat.Nos	Configuration	Colors
10	6 176 40	1 gang unswitched	○ White
10	6 177 40		● Anthracite
10	6 178 40 <sup>1</sup>		○ Ivory
5	6 176 45	2 gang unswitched	○ White
5	6 177 45		● Anthracite
5	6 178 45 <sup>1</sup>		○ Ivory
10	6 176 43	1 gang double pole switched	○ White
10	6 177 43		● Anthracite
10	6 178 43 <sup>1</sup>		○ Ivory
5	6 176 48	2 gang double pole switched	○ White
5	6 177 48		● Anthracite
5	6 178 48 <sup>1</sup>		○ Ivory

**British Standard socket outlets 13 A - 250 V~ with USB charger**

Pack	Cat.Nos	Configuration	Colors
1	6 176 57	1 gang unswitched	○ White
1	6 177 57		● Anthracite
1	6 178 57 <sup>1</sup>		○ Ivory

USB A-Type 2.4 A - 5 V<sub>DC</sub> - 12 W  
Consumption in passive mode < 0.08 W

Belanko™ S

fused connection units and cable outlets



6 176 82



6 176 85

Material: Thermoplastic with glossy finish  
Dimensions: 86 x 86 x 9.5 mm (1 gang) / 86 x 146 x 9.5 mm (2 gang)  
Supplied with 2 screws M3.5 for BS boxes

**Fused connection units 13 A**

Pack	Cat.Nos	Configuration	Colors
Conform to BS 1363-4			
10	6 176 80	Unswitched + cord outlet	○ White
10	6 177 80		● Anthracite
10	6 178 80 <sup>1</sup>		○ Ivory
10	6 176 81	Switched + cord outlet	○ White
10	6 177 81		● Anthracite
10	6 178 81 <sup>1</sup>		○ Ivory
10	6 176 60	Unswitched + neon + cord outlet	○ White
10	6 177 60		● Anthracite
10	6 178 60 <sup>1</sup>		○ Ivory
10	6 176 82	Switched + neon + cord outlet	○ White
10	6 177 82		● Anthracite
10	6 178 82 <sup>1</sup>		○ Ivory

**Cable outlets**

Pack	Cat.Nos	Configuration	Colors
Conform to BS 5733			
10	6 176 85	20 A - 250 V~	○ White
10	6 177 85		● Anthracite
10	6 178 85 <sup>1</sup>		○ Ivory
10	6 176 86	45 A - 250 V~	○ White
10	6 177 86		● Anthracite
10	6 178 86 <sup>1</sup>		○ Ivory

1: Available on request

Belanko™ S

blanking plates and accessories



6 176 28



6 176 37 + 5 720 72



6 176 36



6 133 50



6 133 51

**Blanking plates**

Pack	Cat.Nos	Configuration	Colors
Conform to BS 5733			
10	6 176 28	1 gang	○ White
10	6 177 28		● Anthracite
10	6 178 28 <sup>1</sup>		○ Ivory
5	6 176 39	2 gang	○ White
5	6 177 39		● Anthracite
5	6 178 39 <sup>1</sup>		○ Ivory

**Arteor adaptor**

Pack	Cat.Nos	Configuration	Colors
Allows the integration of 2 modules Arteor mechanisms such as R.C.B.O., automatic switch, skirting lights, USB charger, etc			
20	6 176 37	1 gang	○ White

1: Available on request

**Fixing accessories**

Pack	Cat.Nos	Configuration	Colors
<b>Splash-proof cover</b> Mainly for socket protection IP 55 with or without plug engaged Space inside : 86 x 86 mm			
2	6 176 36	1 gang	● Mist grey

**Surface-mounting boxes**

Pack	Cat.Nos	Configuration	Colors
Conform to BS 5733 Depth 35 mm			
8	6 133 50	1 gang	○ White
4	6 133 51	2 gang	○ White

For integration of Arteor functions, see Arteor offer





## Belanko™ S white and colours

selection chart (continued)

		Pack	White	Anthracite	Ivory
<b>DOUBLE POLE SWITCHES 45 A - 250 V~</b>					
1 gang - 1-way switch		10	6 176 75	6 177 75	6 178 75 <sup>1</sup>
1 gang - 1-way switch + red neon indicator		10	6 176 76	6 177 76	6 178 76 <sup>1</sup>
2 gang - 1-way vertical switch + red neon indicator		10	6 176 77	6 177 77	6 178 77 <sup>1</sup>
<b>COOKER CONTROL UNIT - 250 V</b>					
45 A DP switch + red neon and 13 A BS switched socket outlet + red neon		5	6 176 78	6 177 78	6 178 78 <sup>1</sup>
<b>DIMMERS</b>					
500 W RL dimmer		1	6 176 31	6 177 31	6 178 31 <sup>1</sup>
300 W RLC+LED dimmer		1	6 176 35	6 177 35	6 178 35 <sup>1</sup>
<b>VENTILATION CONTROL</b>					
Fan control 250 V~ - 50 Hz		1	6 176 33	6 177 33	6 178 33 <sup>1</sup>
<b>TELEVISION SOCKETS</b>					
Single TV socket, female		10	6 176 27	6 177 27	6 178 27 <sup>1</sup>
Single TV socket, "F" type		10	6 176 26	6 177 26	6 178 26 <sup>1</sup>
Double TV socket, female + "F" type		10	6 176 38	6 177 38	6 178 38 <sup>1</sup>
TV-R socket		10	6 176 30	6 177 30	6 178 30 <sup>1</sup>
<b>TELEPHONE SOCKETS</b>					
RJ 11 socket		10	6 176 97	6 177 97	6 178 97 <sup>1</sup>
Double RJ 11 socket		10	6 176 98	6 177 98	6 178 98 <sup>1</sup>

1: Available on request

## Belanko™ S white and colours

selection chart

		Pack	White	Anthracite	Ivory
<b>PUSH-BUTTONS 6 A - 250 V~</b>					
1 gang		10	6 176 10	6 177 10	6 178 10 <sup>1</sup>
2 gang		10	6 176 15	6 177 15	6 178 15 <sup>1</sup>
Bell push		10	6 176 11	6 177 11	6 178 11 <sup>1</sup>
2 gang for shutters		10	6 176 16	6 177 16	6 178 16 <sup>1</sup>
<b>DOUBLE POLE SWITCHES 20 A - 250 V~</b>					
1 gang - 1-way switch		10	6 176 73	6 177 73	6 178 73 <sup>1</sup>
1 gang - 1-way switch + red neon indicator		10	6 176 70	6 177 70	6 178 70 <sup>1</sup>
1 gang - 1-way switch + red neon indicator + earth connection		10	6 176 71	6 177 71	6 178 71 <sup>1</sup>
1 gang - 1-way switch + red neon indicator + earth connection with "Water Heater" marking		10	6 176 72	6 177 72	6 178 72 <sup>1</sup>

1: Available on request



## Belanko™ S white and colours

selection chart (continued)

		Pack	White	Anthracite	Ivory
<b>DATA SOCKETS</b>					
RJ 45 Cat.6 UTP		10	6 176 91	6 177 91	6 178 91 <sup>1</sup>
Double RJ 45 Cat.6 UTP		10	6 176 92	6 177 92	6 178 92 <sup>1</sup>
Single Keystone adaptor - 1 gang		10	6 176 17	6 177 17	6 178 17 <sup>1</sup>
Double Keystone adaptor - 2 gang		10	6 176 34	6 177 34	6 178 34 <sup>1</sup>
<b>HOTEL EQUIPMENT</b>					
Key card switch 16 A - 230 V - 50/60 Hz		1	6 176 12	6 177 12	6 178 12 <sup>1</sup>
Hotel bedroom call indicator - Indicator for corridor		10	6 176 13	6 177 13	6 178 13 <sup>1</sup>
Hotel bedroom call indicator - Internal control unit		10	6 176 14	6 177 14	6 178 14 <sup>1</sup>
Shaver socket 115/230 V - 20 VA - 50/60 Hz 2 gang		1	6 176 08	6 177 08	6 178 08 <sup>1</sup>
<b>SECURITY SWITCH</b>					
Panic button 1 A resistive - 250 V~		1	6 176 19	6 177 19	6 178 19 <sup>1</sup>
<b>BRITISH STANDARD SOCKET OUTLETS 13 A - 250 V~</b>					
1 gang unswitched		10	6 176 40	6 177 40	6 178 40 <sup>1</sup>
2 gang unswitched		5	6 176 45	6 177 45	6 178 45 <sup>1</sup>
1 gang unswitched + USB charger A-Type 2.4 A		1	6 176 57	6 177 57	6 178 57 <sup>1</sup>
1 gang double pole switched		10	6 176 43	6 177 43	6 178 43 <sup>1</sup>
2 gang double pole switched		5	6 176 48	6 177 48	6 178 48 <sup>1</sup>

1: Available on request

## Belanko™ S white and colours

selection chart (continued)





		Pack	White	Anthracite	Ivory
<b>FUSED CONNECTION UNITS</b>					
Unswitched + cord outlet		10	6 176 80	6 177 80	6 178 80 <sup>1</sup>
Unswitched + neon + cord outlet		10	6 176 60	6 177 60	6 178 60 <sup>1</sup>
Switched + cord outlet		10	6 176 81	6 177 81	6 178 81 <sup>1</sup>
Switched + neon + cord outlet		10	6 176 82	6 177 82	6 178 82 <sup>1</sup>
<b>CABLE OUTLETS</b>					
20 A - 250 V~		10	6 176 85	6 177 85	6 178 85 <sup>1</sup>
45 A - 250 V~		10	6 176 86	6 177 86	6 178 86 <sup>1</sup>
<b>BLANKING PLATES</b>					
1 gang		10	6 176 28	6 177 28	6 178 28 <sup>1</sup>
2 gang		5	6 176 39	6 177 39	6 178 39 <sup>1</sup>
<b>ARTEOR ADAPTOR</b>					
1 gang		20	6 176 37	-	-

1: Available on request



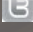

## FOLLOW US ALSO ON

-  [www.legrand.sa](http://www.legrand.sa)
-  [youtube.com/legrandksa](https://youtube.com/legrandksa)
-  [twitter.com/legrandksa](https://twitter.com/legrandksa)
-  [facebook.com/legrandksa](https://facebook.com/legrandksa)
-  [linkedin.com/company/legrand-ksa](https://linkedin.com/company/legrand-ksa)

### **Riyadh**

Localizer Mall , Office No. F6,  
1<sup>st</sup> Floor P.O.Box: 325099  
Prince Muhammad Ibn Abd Al Aziz,  
Al Olaya, Riyadh 12222

### **Al-Khobar**

Al-Khobar Mall  
2<sup>nd</sup> Floor, office 362  
P.O.Box 927, Al Khobar 31953, KSA  
Tel: +966 13 887 89 50  
Fax: +966 13 887 89 52



### **Jeddah (Head Office)**

Al-Reem Business Center, 2<sup>nd</sup> Floor  
Al-Rawdah District  
P.O.Box:51712  
Jeddah, 21553, KSA  
Tel: +966 12 261 96 96  
Fax: +966 12 261 97 97